

Exhibition reservation form

Please tick all that apply

Display Spaces

C, D, E, F, G, H, I, J, L	2m x 1m	£295.00	<input type="checkbox"/>
B	2.5m x 1m	£345.00	<input type="checkbox"/>
A, K	3m x 1m	£395.00	<input type="checkbox"/>

Literature Distribution

Exhibitors	£95.00	<input type="checkbox"/>
Non exhibitors	£125.00	<input type="checkbox"/>
Extra delegate (each)	£90.00	<input type="checkbox"/>

SUB TOTAL	£	_____
VAT @ 20%	£	_____
TOTAL AMOUNT DUE	£	_____

Cheques should be made payable to HALL-MCCARTNEY LTD

We are not anticipating any problems, but neither the Museum of Science and Industry, the IHBC nor Hall-McCartney can accept any responsibility for loss or damage. On receipt of your booking and instructions, we will issue you with an invoice to be settled within 30 days or by 2 September 2011, whichever is the sooner.

Signed _____

Name in block letters _____

Name(s) of company delegates _____

Company name _____

Address _____

Postcode _____

Telephone _____

Fax _____

Email _____

Website _____

Please return to: Geoff Connelly, Hall-McCartney Ltd, Heritage House,
PO Box 21, Baldock, Herts SG7 5SH
Tel: 01462 896688 Fax: 01462 896677
Email: geoff@hall-mccartney.co.uk

HML

DAY CONFERENCE

Historic buildings: local action

Friday 23 September 2011

The objective of the Government's Localism Bill is to empower local communities and encourage volunteers to play an increasing role in improving their local areas. It offers scope for decision-making at the lowest practical level, shifting power from central government into the hands of individuals, communities and local authorities. This, it is maintained, will enable greater innovation and deliver better value for taxpayers' money.

Combined with public expenditure cuts and the Government's vision for the 'Big Society', the movement towards localism represents the largest potential shake-up of the planning system for many years. How will this affect the historic environment?

So far the focus of the heritage sector has been to counter perceived threats to historic buildings by allowing local planning procedures to override national cultural priorities.

This conference will look beyond current conflicts, and explore the ways in which local initiatives might unlock the potential for the historic environment to play a greater role in shaping the future of towns and villages.

Museum of Science and Industry
Liverpool Road
Castlefield
Manchester
M3 4FP

www.mosi.org.uk



Exhibition
space
available



DAY CONFERENCE

Historic buildings: local action

Friday 23 September 2011

at the

Museum of
Science and Industry
Liverpool Road
Castlefield
Manchester
M3 4FP

CONFERENCES & EXHIBITIONS

Hall-McCartney Ltd

Tel: 01462 896688

Fax: 01462 896677

Email: geoff@hall-mccartney.co.uk

www.hall-mccartney.co.uk

The Invitation

If your company specialises in historic building and landscape conservation you are invited to promote your products and services on Friday 23 September 2011.

The Opportunity

- Taking a display space at The Exhibition
- Booking the literature distribution service

The IHBC is the principal UK organisation responsible for the preservation of historic structures, conservation areas and landscapes. Members work mainly in local authorities and other publicly funded bodies like English Heritage, but also in private practice and UK conservation bodies.

The Delegates will include surveyors, planners, architects, conservation officers, urban designers, structural engineers and heritage managers involved in the care and conservation of the sustainable and historic environment. Conference organisers the NW Branch of the IHBC have a catchment area from the Isle of Man to Greater Manchester, including Chester, Merseyside and Lancs and will have a strong presence. Invitations will also be extended nationwide and should attract over 100 delegates all of whom will have a significant influence on the use and choice of materials and services in both the public and private sectors.

The Venue The event will take place in the Museum of Science and Industry. It is 20 minutes walk from Manchester's main city centre railway stations, and close to bus stops. Public car parking is available on site.

The Exhibition Exhibitors will be reserving floor space only and must bring their own free-standing display panels. Products and equipment can be placed in front of spaces to a depth of one metre. The location of the exhibition area and the numerous refreshment breaks will provide good exposure of your display.

Programme Friday 23 September 2011

- 09.30 Registration and coffee
- 09.45 Welcome – Paul Hartley, IHBC NW Branch Chair & Jo Evans, IHBC Chair
Chair for the day: Mike Brown, IHBC Policy Secretary
- Setting the Scene: Localism in the Historic Environment**
- 09.50 Empowering Local Communities – Chris Smith OBE, English Heritage
- 10.15 What is localism and what does it really mean for heritage? – Dave Chetwyn DJC1 Planning
- 10.40 Asset Transfer – Hugh Rollo, Development Trust Association
- 11.00 Coffee
- Local Management of Historic Assets**
- 11.15 Developing the Civic Voice – Tony Burton, Civic Voice
- 11.35 Local Action for Pride of Place – Professor Ian Wray, Oxtan Society
- 11.55 Social Enterprise and Sustainable Communities – Elaine Griffith MBE, Gorton Monastery
- 12.15 Compiling a Local List – Michael Scammell

- 12.35 Discussion and summary
- 12.45 Lunch

Localism in Action

- 13.40 Tours
Canals – led by Jonathan Schofield
MOSI Tours + breakout session with Stephen Langtree
Liverpool Road Gateway – led by Carol Middleton & Ian Christie, Castlefield Forum

- 15.00 Tea

Project Delivery

- 15.20 Funding Local Action – Sara Hilton, HLF
- 15.50 Raising the Stakes – David Trevis-Smith, UK APT
- 16.20 Discussion and summary
- 16.30 Close

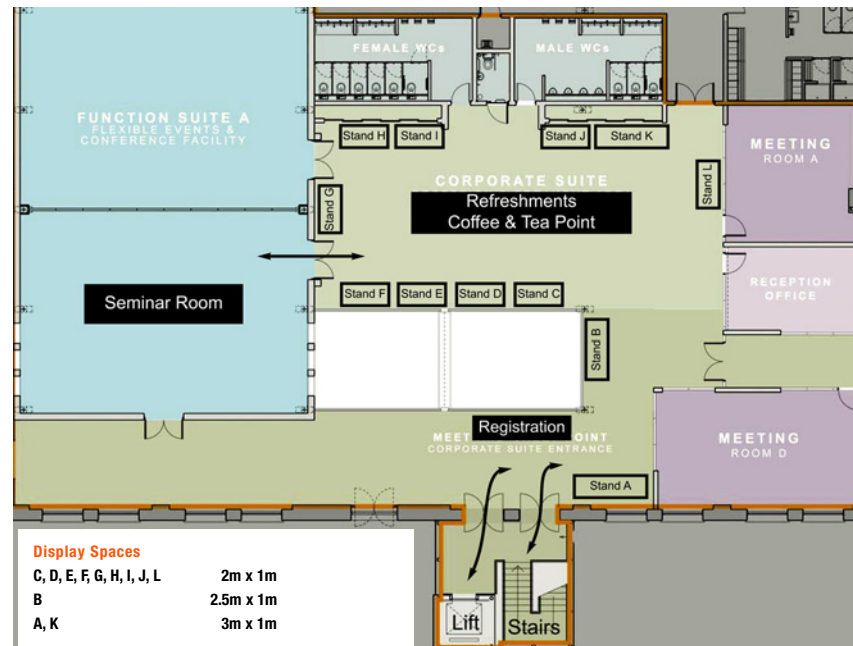

Conference Floor Plan (not to scale)

Set up 07.00–09.00 Friday 23 September 2011 Breakdown approx 16.45

Literature Distribution Service We are offering a service to distribute product information to all delegates at the event on registration in The Special Conservation Portfolio. This service is available to both exhibitors and non-exhibitors. You will need to supply 150 copies of the item you wish to have included in the Conservation Portfolio by 2 September 2011. The prices quoted are based on one item weighing not more than 25gms. If you wish to include heavier items, please ask for a separate quotation.

Please telephone to confirm availability of display space before completing the application form, as there is room for only 12 exhibitors.

Contact: Geoff Connelly
Hall-McCartney Ltd
Heritage House
Baldock
Hertfordshire SG7 5SH

Tel: 01462 896688
Email: geoff@hall-mccartney.co.uk