



Organised by **The Gardens Trust**
70 Cowcross Street, London EC1M 6EJ
Phone: (+44/0) 207 608 2409
Email: enquiries@thegardenstrust.org
Exhibition Stand Enquiries:
josie@hall-mccartney.co.uk
01462 896688

New Town Landscapes: Learning from the Past, Shaping the Future

23rd & 24th September 2026, Sky Room, MK Gallery, Milton Keynes

LITERATURE DISTRIBUTION and STAND SPACE OPPORTUNITY

to key influential professionals involved in preserving, maintaining,
restoring and promoting the country's garden heritage.

The Gardens Trust's 2026 Historic Landscape Assemblies will focus on the theme of 'New Town Landscapes: Learning from the Past, Shaping the Future'. An unmissable opportunity for all those with a stake in historic designed landscapes and their conservation to meet and discuss current issues.

This two-day conference will bring together academics, practitioners, policymakers, and those with direct experience of New Town development to explore how the histories of New Towns can inform their futures.

The conference is conceived as both a scholarly forum and a space for professional and intergenerational exchange, encouraging dialogue between research, practice, and lived experience.

Invited delegates will be key personnel from, County Gardens Trusts, the IHBC, Amenity Societies, Building Preservation Trusts, Landscape Practices, National Lottery Heritage Fund, Heritage Open Days, National Trust, Historic Houses, the Arts Society, Garden Museum, Historic England, English Heritage, CPRE, Natural England, local authority planning departments, local authority Historic Environment Records.

LITERATURE DISTRIBUTION and STAND SPACE OPPORTUNITY

We are delighted to offer a limited number of display stands and the opportunity to distribute your product literature to all delegates attending the event on the day by including your insert in the delegate pack. The Exhibition Display stand spaces are only available on 23rd September.

Speakers will include representatives from Historic England and The Gardens Trust Conservation Committee.

Historic Landscapes Assembly

New Town Landscapes: Learning from the Past, Shaping the Future

23rd September 2026, 9.30am - 5.00pm, Sky Room, MK Gallery, Milton Keynes

PROGRAMME:

23RD SEPTEMBER

- 9.30 Tea/coffee available
- 10.00 Welcome from John Watkins, GT Chair
- 10.05 Keynote address
- 10.20 **Building the Future: Britains New Towns**, Dr Alistair Fair, Reader in Architectural History, University of Edinburgh
- 10.50 **New Jerusalems, New Landscapes: Rethinking Green Space in the New Towns**, Dr Alina Congreve, education professional
- Coffee
- 11.30 **From Britain to America and back: methods of analysis to facilitate a landscape-led masterplan. A case study of Redditch**, Luca Csepely-Knorr, University of Liverpool School of Architecture
- 11.45 **Tracing Ecological Networks across Western Europe: The Transnational Making of Warrington New Town**, Joy Burgess, University of Liverpool School of Architecture
- 12.00 **From Fengshui and Parkway, to Dolphins: New Town Landscapes in Hong Kong**, Juliana Kei, University of Liverpool School of Architecture
- 12.15 Questions for above three sessions
- 12.25 Buckinghamshire Gardens Trust introduction to research on Milton Keynes landscapes
- Lunch
- 1.30 **Future proof New Towns: International lessons on how to build flexible and adaptable new towns**, Dr David Mountain, Research Manager, Royal Town Planning Institute
- 1.50 **Irving No More? Lost Futures in Scotland's Penultimate New Town**, Joss Durnan, Senior Ancient Monuments Officer, Historic Environment Scotland
- 2.10 **Heritage in Practice: Teaching and Learning from the Landscape of Britain's New Towns**, Dr Camilla Allen, Lecturer, School of Architecture and Landscape, Sheffield, and Anna Livingstone, Graduate Masterplanner, CSA Environmental
- 2.30 **Skerningham Garden Village – 'nature-based Design Codes'**, Alan Wann, DesigNE and Peter Owens, Colour

Tea

3.10 Panel discussion with sector professionals and local voices, including the Landscape Institute, Royal Town Planning Institute, National Trust, Royal Horticultural Society, and Central Milton Keynes Town Council

4.10 **New Town public art: connecting past-present-future** Dr Andrew Demetrius: University of St Andrews

5pm Close

24TH SEPTEMBER - no exhibition

9.30 **Introduction to Designed Landscapes within Milton Keynes**
James Cairncross Head of Landscape Architecture, The Parks Trust, Milton Keynes

11.00 **Guided tours of green spaces in Milton Keynes**, including Campbell Park and Great Linford Manor Park, plus the option of tours of the city by bike, offering delegates the opportunity to experience the city firsthand and continue discussions in situ. [More detail to be added.]

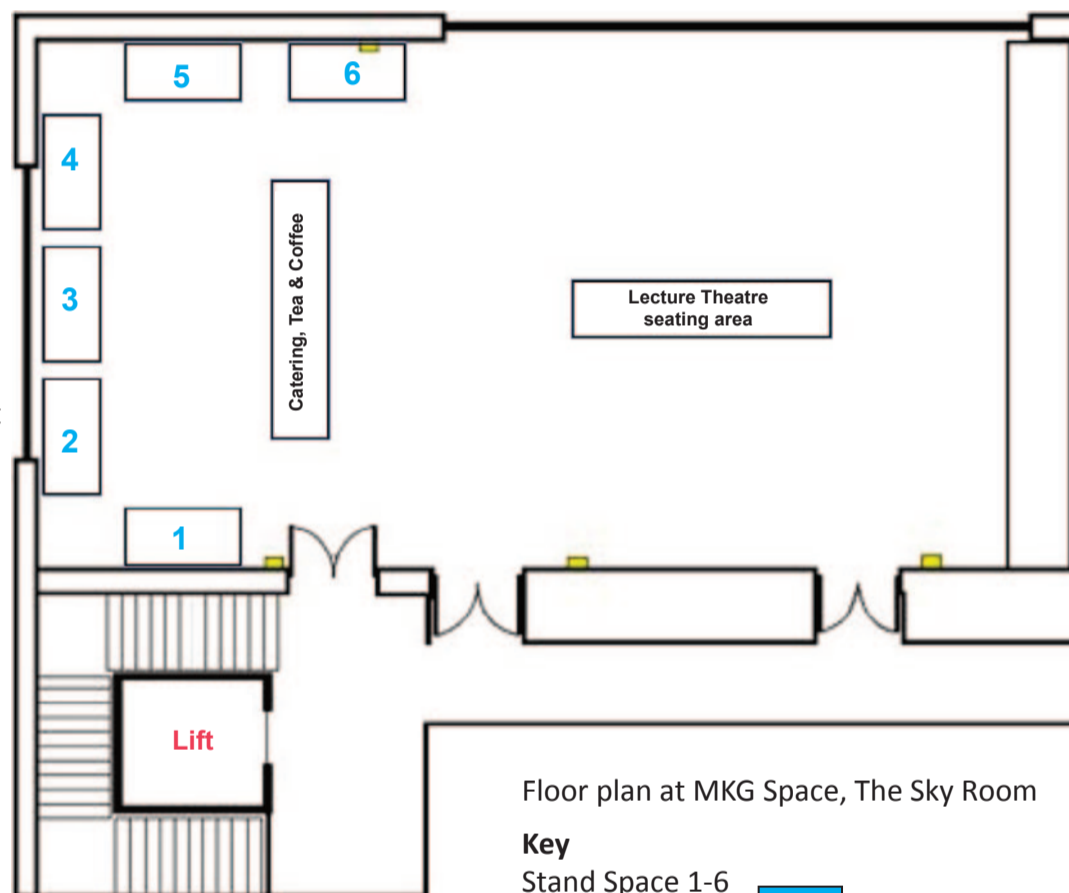

LITERATURE DISTRIBUTION & EXHIBITION RESERVATION FORM

Please telephone to confirm availability of display space before completing the application as there are only 6 stands available.

Please select from the following options and tick all that apply

Display Spaces
Please note: Each stand includes one delegate place (incl tea, coffee, lunch) and literature distribution

Stands 1- 6 2m x 1m £335.00 + VAT

Literture Distribution £95.00 + VAT

Extra delegate (each) £95.00 + VAT

SUB TOTAL £ _____

VAT @ 20% £ _____

TOTAL AMOUNT DUE £ _____

Payments should be made payable to HALL-MCCARTNEY LTD by bank transfer. Details of which will be on the invoice.

We are not anticipating any problems, neither The Gardens Trust nor Hall-McCartney can accept any responsibility for loss or damage. On receipt of your booking and instructions, we will issue you with an invoice to be settled within 14 days.

Name in block letters

Signed

Name(s) of company delegates

Company name

Address

Postcode

Telephone

Email

Website

Please return to:

Josie Woollard, Hall-McCartney Ltd, Heritage House,
PO Box 21, Baldock, SG7 5SH
Tel: 01462 896688
Email: josie@hall-mccartney.co.uk